

ORDINANCE NO. 08-05-1

AN ORDINANCE ANNEXING SECTION 26 AND SECTION 35 AND THE E383.25 W458 N680.5 S1205.5 SW SW AND E294 W752 N680.5 S1205.5 SW SW OF SECTION 25 OF TOWNSHIP 16 NORTH RANGE 15 E OF THE INDIAN BASE AND MERIDIAN, MUSKOGEE, COUNTY, OKLAHOMA TO THE INCORPORATED TOWN OF HASKELL, OKLAHOMA, AND INCLUDING THE SAME WITHIN THE INCORPORATED LIMITS OF SAID TOWN AND DECLARING AN EMERGENCY.

WHEREAS, the Board of Trustees of the Town of Haskell, Oklahoma, has given notice of the intent to annex certain property to the incorporated limits of the Town of Haskell, Oklahoma;

WHEREAS, notice of public hearing concerning annexation has been published in accordance with Section 21-104 of Title 11 of the Oklahoma Statutes and said hearing was held on the 13th day of September, 2005;

WHEREAS, the property to be annexed is contiguous to and adjacent to the Town of Haskell and the Board of Trustees of the Town of Haskell is of the opinion that said territory should be annexed to the Town of Haskell;

WHEREAS, the property to be annexed is subject to annexation under Section 21-104 of Title of the Oklahoma Statutes;

WHEREAS, a map or plat of the above described property is hereto attached and made a part hereof; and

WHEREAS, the Board of Trustees of the Town of Haskell, Oklahoma, has prepared a plan to extend services to the territory as follows:

The Town of Haskell will provide the following corporate services:

1. Police protection shall commence immediately.
2. Fire protection shall commence immediately.
3. Street shall be maintained unless Muskogee County agrees to provide such maintenance.
4. Garbage services will be provided within 60 days.



BE IT ORDAINED BY THE BOARD OF TRUSTEES OF THE INCORPORATED
TOWN OF HASKELL, OKLAHOMA

Section 1: Territory Annexed. That Sections Twenty Six (26) and Thirty Five (35) and the E383.25 W458 N680.5 S1205.5 SW SW and E294 W752 N680.5 S 1205.5 SW SW of Section Twenty Five (25) of Township 16 North Range 15 E of the Indian base and meridian, Muskogee County, Oklahoma be and hereby is annexed to the incorporated limits of the Town of Haskell, Oklahoma, and included within the incorporated limits of the Town of Haskell, Oklahoma, in accordance with 11OSA 21-101 et seq.

Section 2 : Subject to the Provisions of Section 17.32.010 of the Haskell Town Code: Pursuant to Section 17.32.010 of the Haskell Town Code the annexed property shall automatically be zoned "F" Agriculture until rezoned according to said Code.

Section 3: Plan to Extend Service. The Town of Haskell will provide the hereinabove described corporate services.

Section 4: Emergency. An emergency is hereby declared to exist whereby it is necessary for the immediate preservation of the public peace, health and safety, that this Ordinance take effect immediately, and become operative from and after its passage and approval.

PASSED AND APPROVED THIS 13TH DAY OF SEPTEMBER, 2005

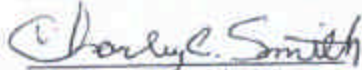
Charley C. Smith, Mayor





Judy Simmons, Town Clerk

AREA TO BE ANNEXED TO THE TOWN OF HASKELL, OKLAHOMA

SECTION 26 AND SECTION 35 AND THE E383.25 W458 N680.5 S1205.5 SW SW AND E294 W752 N680.5 S1205.5 SW SW OF SECTION 25 OF TOWNSHIP 16 NORTH, RANGE 15 E OF THE INDIAN BASE AND MERIDIAN, MUSKOGEE, COUNTY, OKLAHOMA.

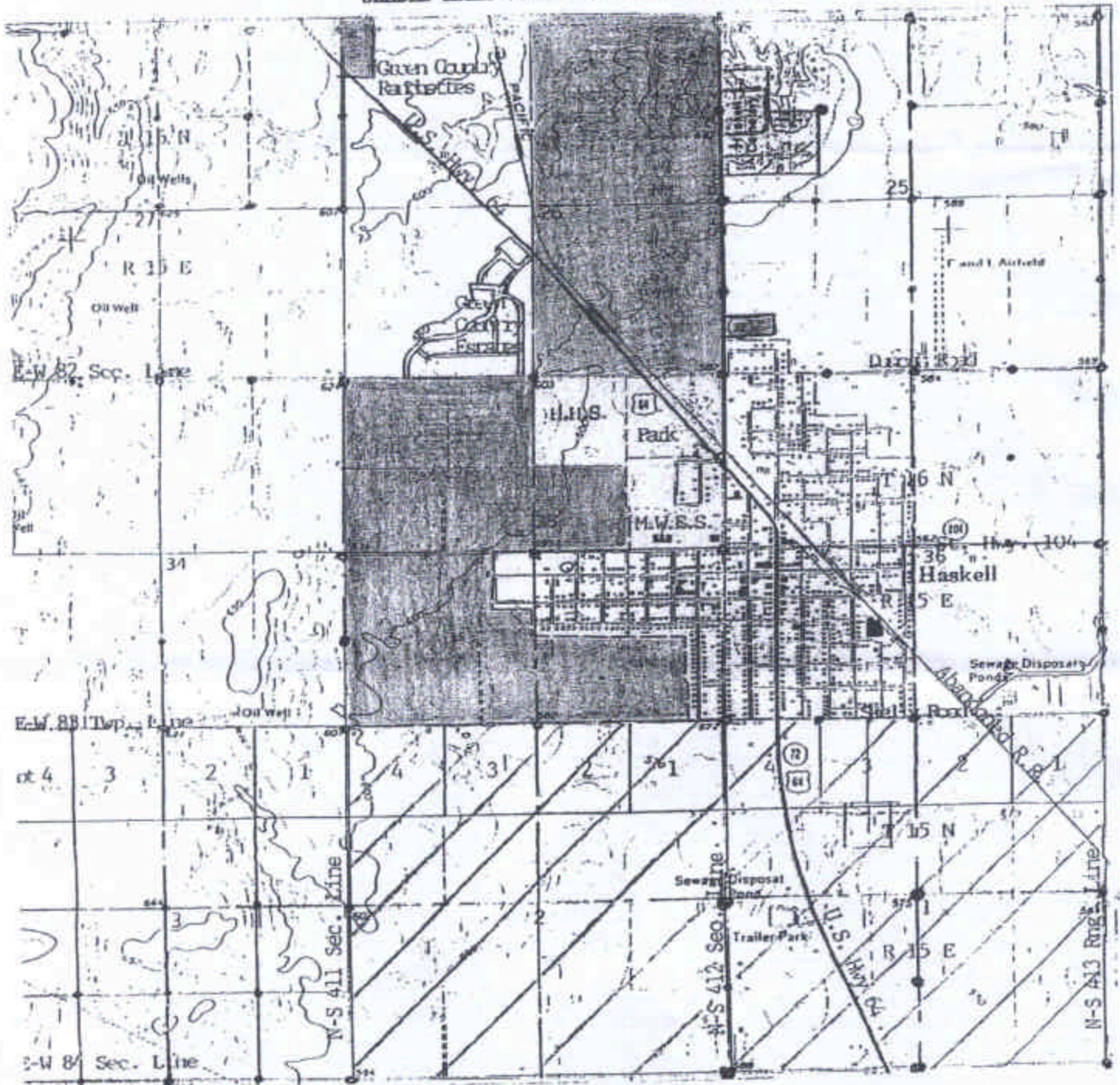
SHADED AREA CONTAINS AREAS TO BE ANNEXED



Plat of land described above. No survey made or implied. Heavy dots are at corners found in place or set on survey projects in the past 25 years.